

## 191A 088E1 PERROT









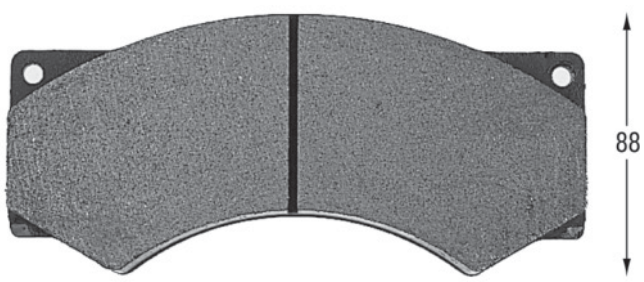

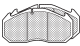

<b>DAF/LEYLAND</b>	F45-SERIES 	37
	ROADRUNNER 	37
<b>DAF</b>	1000 SERIES 	39
	F45-SERIES 	45

### WVA #

29017 23 4



				#
<b>4499</b> ☆ ☆			<b>541643</b>	4

				Max min	ABS 	#
	Ø 312	30	>	27	F	<b>187079</b> 2

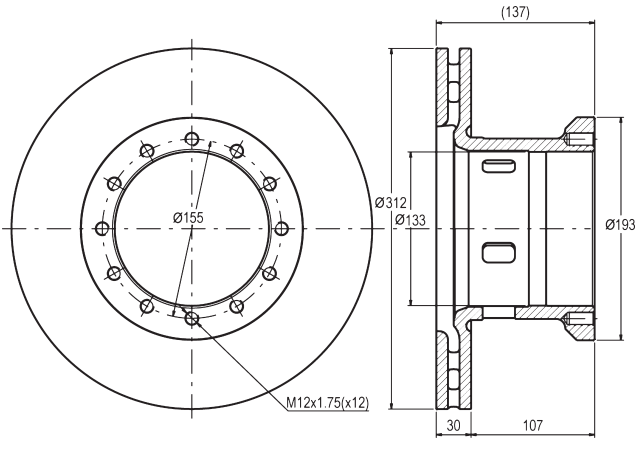

## 191A 088E2 PERROT









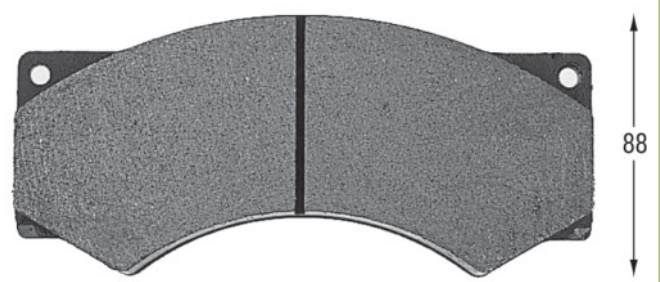

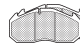

<b>IVECO</b>	FIAT Z-SERIES 	63
	ZETA 	68

### WVA #

29017 23 4



				#
<b>4499</b> ☆ ☆	2		<b>541614</b>	4

				Max min	ABS 	#
	Ø 315	26	>	23	F	<b>187006</b> 2

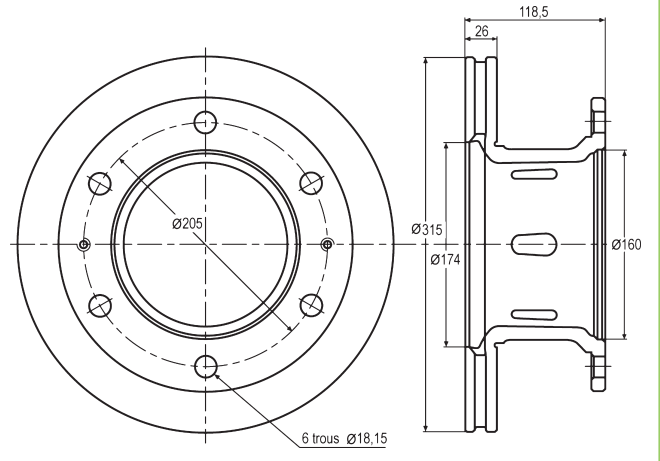



**191A 088E3**

**PERROT**



<b>DAF/LEYLAND</b>	F45-SERIES	37
	ROADRUNNER	37

**WVA**



<b>29017</b>	23	4
--------------	----	---

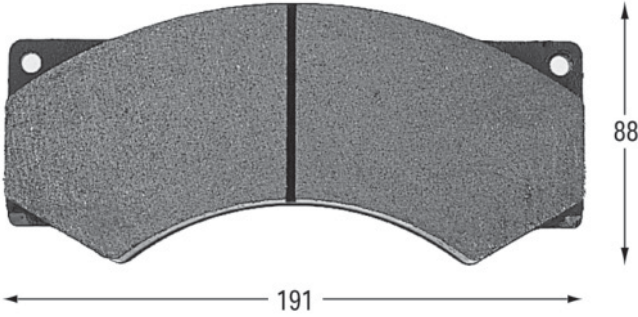

					#
<b>4499</b> ☆ ☆	2	⊕	<b>541614</b>	4	

					<b>ABS</b>		#
		Max	min			43 2 1	
	Ø 315	26	> 23	F	<b>187078</b>	2	

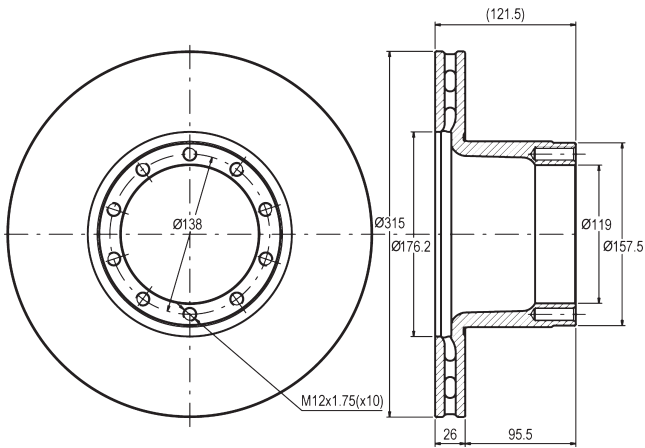

**191A 088E4**

**PERROT**



<b>DAF/LEYLAND</b>	F45-SERIES	37
	ROADRUNNER	37

**WVA**



<b>29017</b>	23	4
--------------	----	---

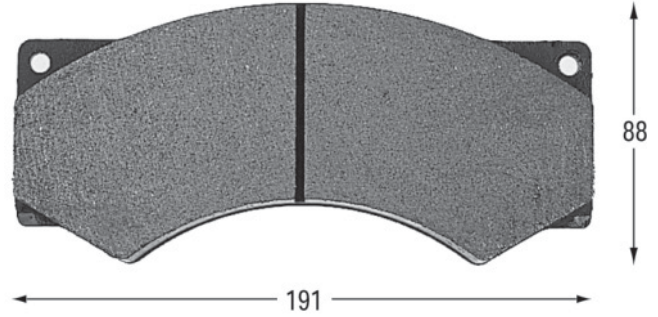

					#
<b>4499</b> ☆ ☆	2	⊕	<b>541614</b>	4	

					<b>ABS</b>		#
		Max	min			43 2 1	
	Ø 312	30	> 27	F	<b>187079</b>	2	

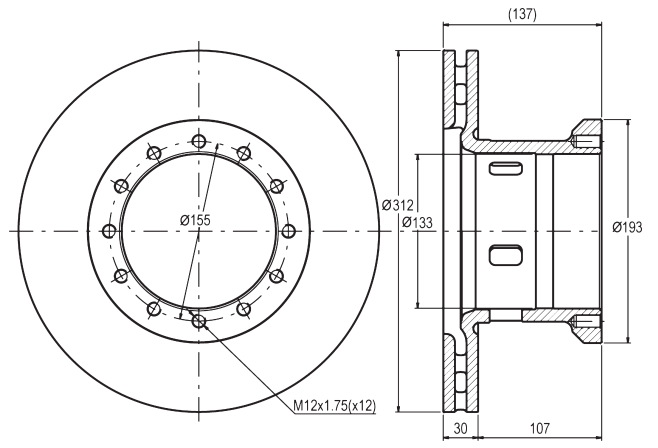



## 204A 097E0

LUCAS



<b>RENAULT TRUCKS</b>	MAGNUM/AE	161
	R	167
	R-SERIES	169

### WVA

29043

#  
24 4

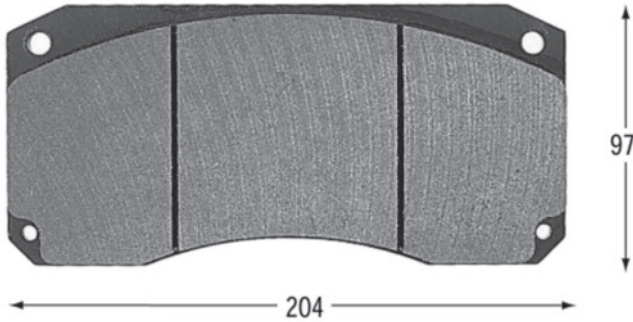

					#
4405 ☆ ☆	2Y	580	541648	4	

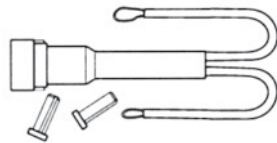

4405 ☆ ☆	2+	541605	4
----------	----	--------	---

				Max	Min	ABS		#
Ø 440	44,4 > 39,4	F	187022	2			43 2 1	

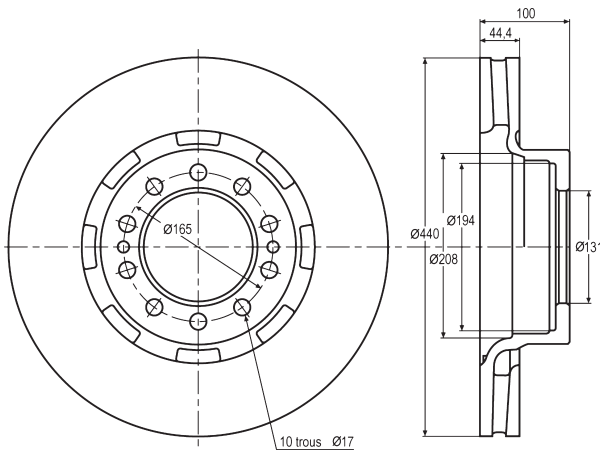

## 204A 097E1

LUCAS



<b>RENAULT TRUCKS</b>	MAGNUM/AE	161
	R	167

### WVA

29043

#  
24 4

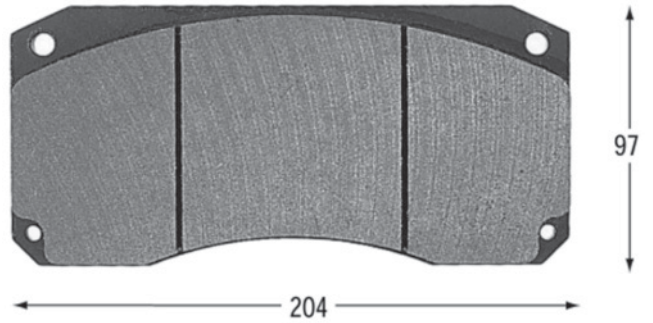

					#
4405 ☆ ☆	2Y	580	541648	4	

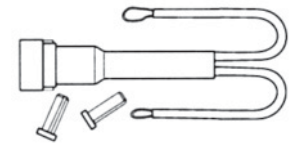

4405 ☆ ☆	2+	541605	4
----------	----	--------	---

			Max	Min	ABS		#
Ø 438	45 > 41	F	187024	2		43 2 1	

